

- *Index*
- *Cabinet Selection*

Tall Cabinetry

Page Location	Cabinet Type	Nomenclature
109	Oven Cabinets - Double	OC
109	Oven Cabinets - Single	OC
110	Oven Cabinets - Double - Warming Drawer	OC-WDR
110	Oven Trim Kit	OTK
110	Oven Trim Kit Full	OTKF
108	Utility Blind End Cabinets	UBEC
107	Utility Cabinets - 12" Depth	UC
108	Utility Cabinets - 12" Depth - 102" HIGH	UC
107	Utility Cabinets - 24" Depth	UC
108	Utility Cabinets - 24" Depth - 102" HIGH	UC
107	Utility Cabinets - 24" Depth - 4 Pull Out Trays	UC-4T
108	Utility End Cabinets	UEC

Tall Cabinetry : Cabinet Selection

Tall Cabinets

	W	H	D	Cabinet Door and Drawer head	
--	---	---	---	---------------------------------	--

Utility Cabinets (12" Deep) - Height: 84"

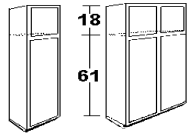

UC1584 L/R	15	84	12	• (1) DR1518 (1) DR1561
UC1884 L/R	18	84	12	• (1) DR1818 (1) DR1861
UC2484	24	84	12	• (2) DR1218 (2) DR1261
UC3084	30	84	12	• (2) DR1518 (2) DR1561

Full Access Construction

No Shelf in Upper Section
Loose Toekick
Pantry Shelf Kits (PSK) sold separately

Utility Cabinets (12" Deep) - Height: 90"

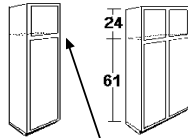

UC1590 L/R	15	90	12	• (1) DR1524 (1) DR1561
UC1890 L/R	18	90	12	• (1) DR1824 (1) DR1861
UC2490	24	90	12	• (2) DR1224 (2) DR1261
UC3090	30	90	12	• (2) DR1524 (2) DR1561

Full Access Construction

(1) Adjustable Shelf in Upper Section
Loose Toekick
Pantry Shelf Kits (PSK) sold separately

Note: In VHS there is approximately a 1 1/4" reveal between upper and lower doors

Utility Cabinets (12" Deep) - Height: 96"

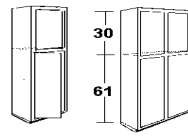

UC1596 L/R	15	96	12	• (1) DR1530 (1) DR1561
UC1896 L/R	18	96	12	• (1) DR1830 (1) DR1861
UC2496	24	96	12	• (2) DR1230 (2) DR1261
UC3096	30	96	12	• (2) DR1530 (2) DR1561

Full Access Construction

(2) Adjustable Shelves in Upper Section
Loose Toekick
Pantry Shelf Kits (PSK) sold separately

Utility Cabinets (24" Deep) - Height: 84"

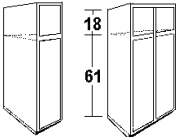

UC158424 L/R	15	84	24	• (1) DR1518 (1) DR1561
UC188424 L/R	18	84	24	• (1) DR1818 (1) DR1861
UC248424	24	84	24	• (2) DR1218 (2) DR1261
UC308424	30	84	24	• (2) DR1518 (2) DR1561

Full Access Construction

No Shelf in Upper Section
(1) Fixed 12" Deep Midshelf in Bottom Section
Loose Toekick
Full Depth Shelf Kits (FDSK) sold separately
Pullout Tray Kits (POT) sold separately

Utility Cabinets (24" Deep) - Height: 84" - 4 PULL OUT TRAYS INSTALLED

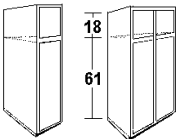

UC158424 L/R-4T	15	84	24	• (1) DR1518 (1) DR1561
UC188424 L/R-4T	18	84	24	• (1) DR1818 (1) DR1861
UC248424-4T	24	84	24	• (2) DR1218 (2) DR1261
UC308424-4T	30	84	24	• (2) DR1518 (2) DR1561

Full Access Construction

No Shelf in Upper Section
(1) Fixed 12" Deep Midshelf in Bottom Section
Loose Toekick
4 Pull Out Trays Factory Installed

Utility Cabinets (24" Deep) - Height: 90"

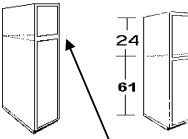

UC159024 L/R	15	90	24	• (1) DR1524 (1) DR1561
UC189024 L/R	18	90	24	• (1) DR1824 (1) DR1861
UC249024	24	90	24	• (2) DR1224 (2) DR1261
UC309024	30	90	24	• (2) DR1524 (2) DR1561

Full Access Construction

(1) Adjustable Shelf in Upper Section
(1) Fixed 12" Deep Midshelf in Bottom Section
Loose Toekick
Full Depth Shelf Kits (FDSK) sold separately
Pullout Tray Kits (POT) sold separately

Note: In VHS there is approximately a 1 1/4" reveal between upper and lower doors

Utility Cabinets (24" Deep) - Height: 90" - 4 PULL OUT TRAYS INSTALLED

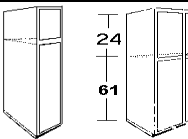

UC159024 L/R-4T	15	90	24	• (1) DR1524 (1) DR1561
UC189024 L/R-4T	18	90	24	• (1) DR1824 (1) DR1861
UC249024-4T	24	90	24	• (2) DR1224 (2) DR1261
UC309024-4T	30	90	24	• (2) DR1524 (2) DR1561

Full Access Construction

(1) Adjustable Shelf in Upper Section
(1) Fixed 12" Deep Midshelf in Bottom Section
Loose Toekick
4 Pull Out Trays Factory Installed

Note: In VHS there is approximately a 1 1/4" reveal between upper and lower doors

Utility Cabinets (24" Deep) - Height: 96"

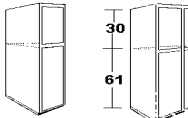

UC159624 L/R	15	96	24	• (1) DR1530 (1) DR1561
UC189624 L/R	18	96	24	• (1) DR1830 (1) DR1861
UC249624	24	96	24	• (2) DR1230 (2) DR1261
UC309624	30	96	24	• (2) DR1530 (2) DR1561

Full Access Construction

(2) Adjustable Shelves in Upper Section
(1) Fixed 12" Deep Midshelf in Bottom Section
Loose Toekick
Full Depth Shelf Kits (FDSK) sold separately
Pullout Tray Kits (POT) sold separately

Utility Cabinets (24" Deep) - Height: 96" - 4 PULL OUT TRAYS INSTALLED

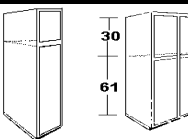

UC159624 L/R-4T	15	96	24	• (1) DR1530 (1) DR1561
UC189624 L/R-4T	18	96	24	• (1) DR1830 (1) DR1861
UC249624-4T	24	96	24	• (2) DR1230 (2) DR1261
UC309624-4T	30	96	24	• (2) DR1530 (2) DR1561

Full Access Construction

(2) Adjustable Shelves in Upper Section
(1) Fixed 12" Deep Midshelf in Bottom Section
Loose Toekick
4 Pull Out Trays Factory Installed

Tall Cabinetry : Cabinet Selection

Tall Cabinets

Utility Cabinets (12" Deep) - Height: 102"		W	H	D	Cabinet Door and Drawer head	Full Access Construction	
		Not Offered In Gatehouse Series					
		UC15102 L/R	15	102	12	• (1) DR1536 (1) DR1561	(2) Adjustable Shelf in Upper Section Loose Toekick Pantry Shelf Kits (PSK) sold separately Standard Plywood Sides
		UC18102 L/R	18	102	12	• (1) DR1836 (1) DR1861	
		UC24102	24	102	12	• (2) DR1236 (2) DR1261	
UC30102	30	102	12	• (2) DR1536 (2) DR1561			

Utility Cabinets (24" Deep) - Height: 102"		W	H	D	Cabinet Door and Drawer head	Full Access Construction	
		Not Offered In Gatehouse Series					
		UC1510224 L/R	15	102	24	• (1) DR1536 (1) DR1561	(2) Adjustable Shelf in Upper Section Loose Toekick Pantry Shelf Kits (PSK) sold separately Standard Plywood Sides
		UC1810224 L/R	18	102	24	• (1) DR1836 (1) DR1861	
		UC2410224	24	102	24	• (2) DR1236 (2) DR1261	
UC3010224	30	102	24	• (2) DR1536 (2) DR1561			

Utility Cabinets (24" Deep) - Height: 102" - 4 PULL OUT TRAYS INSTALLED		W	H	D	Cabinet Door and Drawer head	Full Access Construction	
		Not Offered In Gatehouse Series					
		UC1510224 L/R-4	15	102	24	• (1) DR1536 (1) DR1561	(2) Adjustable Shelf in Upper Section (1) Fixed 12" Deep Midshelf in Bottom Section Loose Toekick 4 Pull Out Trays Factory Installed Standard Plywood Sides Not Offered in Gatehouse Series
		UC1810224 L/R-4	18	102	24	• (1) DR1836 (1) DR1861	
		UC2410224-4	24	102	24	• (2) DR1236 (2) DR1261	
UC3010224-4	30	102	24	• (2) DR1536 (2) DR1561			

Utility End Cabinets		W	H	D	Cabinet Door and Drawer head	Full Access Construction
	UEC84 L/R	24	84	12	• (2) DR1518 (2) DR1561	(5) Fixed Shelves Loose Toekick
	UEC90L/R	24	90	12	• (2) DR1524 (2) DR1561	
	UEC96 L/R	24	96	12	• (2) DR1530 (2) DR1561	(7) Fixed Shelves Loose Toekick
	UEC102 L/R	24	102	12	• (2) DR1536 (2) DR1561	

Note: In VHS there is approximately a 1 1/4" reveal between upper and lower doors for UEC90L/R

CANNOT BE ORDERED WITH FINISHED END OPTION !!!

Utility Blind End Cabinets		W	H	D	Cabinet Door and Drawer head	Full Access Construction
	UBEC84 L/R	24	84	12	• (1) DR1518 (1) DR1561	(5) Fixed Shelves Loose Toekick
	UBEC90 L/R	24	90	12	• (1) DR1524 (1) DR1561	
	UBEC96 L/R	24	96	12	• (1) DR1530 (1) DR1561	(7) Fixed Shelves Loose Toekick

Note: In VHS there is approximately a 1 1/4" reveal between upper and lower doors for UBEC90L/R

CANNOT BE ORDERED WITH FINISHED END OPTION !!!

Tall Cabinetry : Cabinet Selection

Tall Cabinets

Oven Cabinet (Double) - Height: 84" Full Access Construction

		W	H	D	Cabinet Door and Drawer head	
	OC3084L	30	84	24	• (2) DR1518 (1) DH3006	(2) Doors Above (1) Drawer Below No Shelf in Upper Section Loose Toekick (1) 24" deep shelf included for oven installation OTK included at no charge
	OC3384L	33	84	24	• (2) DR1618 (1) DH3306	
	See Page 110 for oven cabinet opening and trim kit sizes.					

Oven Cabinet (Double) - Height: 90" Full Access Construction

	OC3090L	30	90	24	• (2) DR1524 (1) DH3006	(2) Doors Above (1) Drawer Below Loose Toekick (1) 24" deep shelf included for oven installation OTK included at no charge
	OC3390L	33	90	24	• (2) DR1624 (1) DH3306	
	See Page 110 for oven cabinet opening and trim kit sizes.					

Oven Cabinet (Double) - Height: 96" Full Access Construction

	OC3096L	30	96	24	• (2) DR1530 (1) DH3006	(2) Doors Above (1) Drawer Below (1) Adjustable Shelf in Upper Section Loose Toekick (1) 24" deep shelf included for oven installation OTK included at no charge
	OC3396L	33	96	24	• (2) DR1630 (1) DH3306	
	See Page 110 for oven cabinet opening and trim kit sizes.					

Oven Cabinet (Double) - Height: 102" Full Access Construction

	OC30102L	30	102	24	• (2) DR1536 (1) DH3006	(2) Doors Above (1) Drawer Below (2) Adjustable Shelf in Upper Section Loose Toekick (1) 24" deep shelf included for oven installation OTK included at no charge
	OC33102L	33	102	24	• (2) DR1636 (1) DH3306	
	See Page 110 for oven cabinet opening and trim kit sizes.					

Oven Cabinet (Single) - Height: 84" Full Access Construction

	OC3084S	30	84	24	• (2) DR1518 (2) DR1524 (1) DH3006	(2) Doors Above (1) Middle Drawer (2) Doors Below (1) Pullout Tray centered in bottom section No Shelf in Upper Section Loose Toekick (1) 24" deep shelf included for oven installation OTK included at no charge
	OC3384S	33	84	24	• (2) DR1618 (2) DR1624 (1) DH3306	
	See Page 110 for oven cabinet opening and trim kit sizes.					

Oven Cabinet (Single) - Height: 90" Full Access Construction

	OC3090S	30	90	24	• (2) DR1524 (2) DR1524 (1) DH3006	(2) Doors Above (1) Middle Drawer (2) Doors Below (1) Pullout Tray centered in bottom section Loose Toekick (1) 24" deep shelf included for oven installation OTK included at no charge
	OC3390S	33	90	24	• (2) DR1624 (2) DR1624 (1) DH3306	
	See Page 110 for oven cabinet opening and trim kit sizes.					

Oven Cabinet (Single) - Height: 96" Full Access Construction

	OC3096S	30	96	24	• (2) DR1530 (2) DR1524 (1) DH3006	(2) Doors Above (1) Middle Drawer (2) Doors Below (1) Pullout Tray centered in bottom section (1) Adjustable Shelf in Upper Section Loose Toekick (1) 24" deep shelf included for oven installation OTK included at no charge
	OC3396S	33	96	24	• (2) DR1630 (2) DR1624 (1) DH3306	
	See Page 110 for oven cabinet opening and trim kit sizes.					

Tall Cabinetry : Cabinet Selection

Tall Cabinets

	W	H	D	Cabinet Door and Drawer head	
Oven Cabinet (Double) - Warming Drawer - Height: 84"					
	OC3084L-WDR	30	84	24	• (2) DR1518
	OC3384L-WDR	33	84	24	• (2) DR1618
					Full Access Construction (2) Doors Above (1) Warming Drawer Below No Shelf in Upper Section Loose Toekick (1) 24" deep shelf included for oven installation OTKF Full Overlay Included
Oven Cabinet (Double) - Warming Drawer - Height: 90"					
	OC3090L-WDR	30	90	24	• (2) DR1524
	OC3390L-WDR	33	90	24	• (2) DR1624
					Full Access Construction (2) Doors Above (1) Warming Drawer Below Loose Toekick (1) 24" deep shelf included for oven installation OTKF Full Overlay Included
Oven Cabinet (Double) - Warming Drawer - Height: 96"					
	OC3096L-WDR	30	96	24	• (2) DR1530
	OC3396L-WDR	33	96	24	• (2) DR1630
					Full Access Construction (2) Doors Above (1) Warming Drawer Below (1) Adjustable Shelf in Upper Section Loose Toekick (1) 24" deep shelf included for oven installation OTKF Full Overlay Included
Oven Cabinet (Double) - Warming Drawer - Height: 102"					
	OC30102L-WDR	30	102	24	• (2) DR1536
	OC33102L-WDR	33	102	24	• (2) DR1636
					Full Access Construction (2) Doors Above (1) Warming Drawer Below (2) Adjustable Shelf in Upper Section Loose Toekick (1) 24" deep shelf included for oven installation OTKF Full Overlay Included

	W	H	
Oven Trim Kit			
OTK30L	29 3/4	54	
OTK30S	29 3/4	30 5/8	
OTK33L	32 3/4	54	
OTK33S	32 3/4	30 5/8	
OTK30L	29 3/4	54	
OTKF30L-WDR	29 3/4	60 7/8	
OTKF30S	29 3/4	30 5/8	
OTKF33L	32 3/4	54	
OTKF33L-WDR	32 3/4	60 7/8	
OTKF33S	32 3/4	30 5/8	
OTKF3324	32 3/4	24	
OC3084S			
OC3384S			
OC3090S			
OC3390S			
OC3096S			
OC3396S			

	W	H	
Double Oven			
OC3084L OC3384L	29 3/4, 32 3/4	54	
OC3090L OC3390L	29 3/4, 32 3/4	54	
OC3096L OC3396L	29 3/4, 32 3/4	54	
OC30102L OC33102L	29 3/4, 32 3/4	51 3/4	
OTK30L or OTK33L	29 3/4, 32 3/4	54	
OTKF30L or OTKF33L	29 3/4, 32 3/4	54	
OC3084L-WDR OC3384L-WDR	29 3/4, 32 3/4	60 7/8	
OC3090L-WDR OC3390L-WDR	29 3/4, 32 3/4	60 7/8	
OC3096L-WDR OC3396L-WDR	29 3/4, 32 3/4	59 1/4	
OC30102L-WDR OC33102L-WDR	29 3/4, 32 3/4	59 1/4	